

MASHPEE
 ROUTE 151 CORRIDOR IMPROVEMENTS
 STATE: MA PROJECT NO. 807319 SHEET NO. 10/14
 COUNTY: WASHINGTON PROJECT FILE NO. 807319
 PROJECT FILE NO. 807319
 TEMPORARY TRAFFIC CONTROL PLAN
 JETOUR

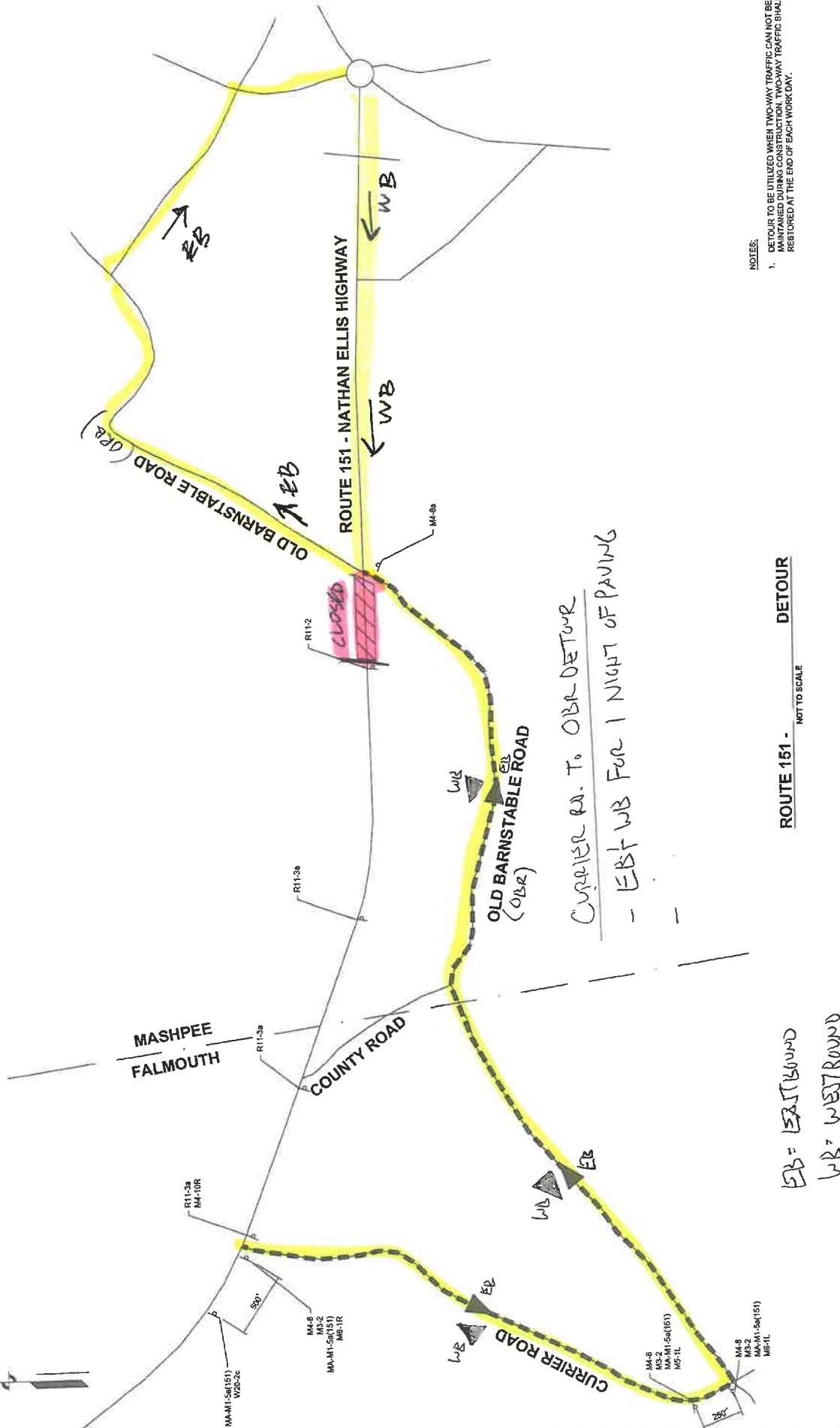

NOTES:
 1. DETOURS TO BE UTILIZED WHEN TWO-WAY TRAFFIC CAN NOT BE MAINTAINED DURING CONSTRUCTION. TWO-WAY TRAFFIC SHALL BE RESTORED AT THE END OF EACH WORK DAY.

ROUTE 151 - DETOUR
 NOT TO SCALE

EB = EASTBOUND
 WB = WESTBOUND